

CORNER HUTCH
800LHS x 800RHS
Includes 1 x half depth support leg

		HEIGHT		
		1080	1380	1680
STYLE	'L' Shape	No Doors (300D)		
	Splay Type	With Doors (350D)		
	'L' Shape	No Doors (300D)		
	Splay Type	With Doors (350D)		

CREDENZA
720mm High

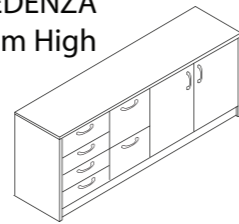

Pictured: 1800mm long with optional 4 x pencil and 2 x file drawers

33mm Top:
(+ 10% to standard price)

	LENGTH	DEPTH	
		450	600
900			
1000			
1100			
1200			
1300			
1400			
1500			
1600			
1700			
1800			
1900			
2000			

Add for 2 x File	
Add For 2 x Twin	
Add For 2 + 1 File	
Add For 4 x Pencil	

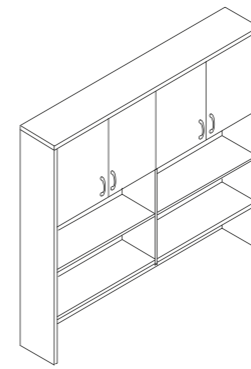

HUTCH
Pictured: 1680mm high with optional doors

		HEIGHT			
		1080 <small>(1080 + 720 = 1800 total)</small>	1380 <small>(1380 + 720 = 2100 total)</small>	1680 <small>(1680 + 720 = 2400 total)</small>	
		No Doors (300D)	No Doors (300D)	With Doors (350D)	No Doors (300D)
900					
1000					
1100					
1200					
1300					
1400					
1500					
1600					
1700					
1800					
1900					
2000					

FILING CABINET
470mm Wide x 600mm Deep

TYPE	Configuration	Height
2 Drawer	720H	
3 Drawer	1050H	
4 Drawer	1380H	

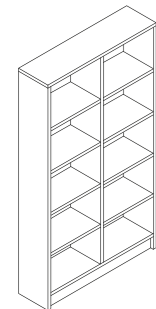
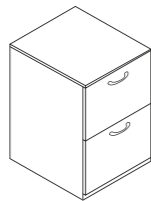

BOOKCASE
No Doors
300mm Deep

		LENGTH									
		900	1000	1100	1200	1300	1400	1500	1600	1700	1800
720	1 S										
900	2 Shelves										
1000											
1100											
1200											
1300											
1400	3 Shelves										
1500											
1600											
1700	4 Shelves										
1800											
1900	5 Shelves										
2000											
2100											
2200											
2300	6 S										
2400											

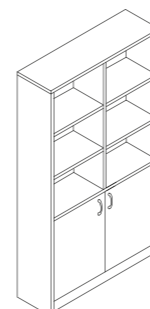

BOOKCASE
With Doors
350mm Deep

		LENGTH									
		900	1000	1100	1200	1300	1400	1500	1600	1700	1800
720	1 S										
900	2 Shelves										
1000											
1100											
1200											
1300											
1400	3 Shelves										
1500											
1600											
1700	4 Shelves										
1800											
1900	5 Shelves										
2000											
2100											
2200											
2300	6 S										
2400											

SHELF LOAD WARNING
Speak to your sales consultant about your storage requirements